

SUMMIT HALLS C & D

SCALE: 1:250 M

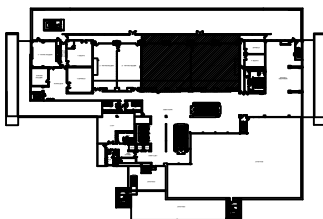

TECHNICAL SPECIFICATION

TOTAL AREA: (SUMMIT HALL C = 338.33 SQ M) + (SUMMIT HALL D = 328.77 SQ M)	667.10 SQ M
CEILING HEIGHT	6.46 M
MEZZANINE HEIGHT	2.40 M
CAPACITY: THEATER	910
CLASSROOM	320
BANQUET (ROUND/RECTANGLE)	530/528
COCKTAIL	530

4TH FLOOR DELEGATION BUILDING

DATE:
09/26/2012