

## SUMMIT HALL C

SCALE: 1:140 M

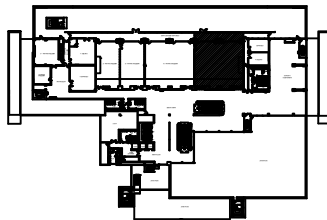

### TECHNICAL SPECIFICATION

TOTAL AREA = 19.50 x 17.35	338.33 SQ M
CEILING HEIGHT	6.46 M
MEZZANINE HEIGHT	2.40 M
CAPACITY: THEATER	382
CLASSROOM	126
BANQUET (ROUND/RECTANGLE)	200/240
COCKTAIL	200

4TH FLOOR DELEGATION BUILDING

DATE:  
09/26/2012